

**HOUSING AUTHORITY OF NEW ORLEANS
BOARD OF COMMISSIONERS
REGULAR MEETING
SEPTEMBER 17, 2013**

RESOLUTION NO. 2013-41

WHEREAS, the Housing Authority of New Orleans (HANO) is the owner of Square 131, otherwise known as "Mazant-Royal", located in the City of New Orleans, State of Louisiana and bounded by Royal Street, France Street, Chartres Street and Mazant Street;

WHEREAS, a re-subdivision was completed in 2008 forming Lots 8-A-1, H, "I", E-1 and F-1 and together with Lots A, B, C, D and G form the entire Square 131;

WHEREAS, HANO has determined that the vacant Lots A, B, C, D, E-1, F-1, H and "I" would better serve the community through a short term lease, not to exceed one year, to the entity, Greener Bywater;

WHEREAS, HANO will continue to maintain and have access to Lots G and 8-A-1 for its own use;

WHEREAS, Greener Bywater will be expected to re-establish and maintain existing fencing and continue grass cutting of the lots herein referenced under the lease agreement and to provide proof of liability insurance in an amount acceptable to HANO with HANO named as co-insured;

THEREFORE, BE IT RESOLVED, the Board of Commissioners of the Housing Authority of New Orleans hereby authorizes its Administrative Receiver to execute any and all documents necessary to effectuate a lease agreement, not to exceed one year, with Greener Bywater for the Mazant-Royal vacant lots as referenced above

EXECUTED this 17th day of September, 2013

APPROVAL:



**DAVID GILMORE,
ADMINISTRATIVE RECEIVER
CHAIRMAN, BOARD OF COMMISSIONERS**



September 17, 2013

MEMORANDUM

**TO: David Gilmore
Administrative Receiver
Chairman, Board of Commissioners**

**FROM: Desiree Andrepont
Director, Real Estate Planning and Development**

**RE: Short-Term Lease of Specific Vacant Lots at the Mazant-Royal
Development to Greener Bywater**

The Housing Authority of New Orleans (HANO) is the owner of Square 131, otherwise known as "Mazant-Royal", which is bounded by Royal Street, France Street, Chartres Street and Mazant Street. Greener Bywater seeks the use of a portion of Mazant-Royal to preserve green space in the neighborhood. A ground lease with Greener Bywater, not to exceed one year, will foster efforts to preserve green space.

Greener Bywater will be expected to re-establish and maintain existing fencing and continue grass cutting under the lease agreement and to provide proof of liability insurance in an amount acceptable to HANO with HANO named as co-insured.

It is requested that the Board of Commissioners authorize the Administrator Receiver to execute any and all documents necessary to enter into a short-term ground lease with Greener Bywater.

- 1" = 10'
- 2" = 20'
- 3" = 30'
- 4" = 40'
- 5" = 50'
- 6" = 60'
- 7" = 70'
- 8" = 80'
- 9" = 90'
- 10" = 100'
- 11" = 110'
- 12" = 120'
- 13" = 130'
- 14" = 140'
- 15" = 150'
- 16" = 160'
- 17" = 170'
- 18" = 180'
- 19" = 190'
- 20" = 200'
- 21" = 210'
- 22" = 220'
- 23" = 230'
- 24" = 240'
- 25" = 250'
- 26" = 260'
- 27" = 270'
- 28" = 280'
- 29" = 290'
- 30" = 300'
- 31" = 310'
- 32" = 320'
- 33" = 330'
- 34" = 340'
- 35" = 350'
- 36" = 360'
- 37" = 370'
- 38" = 380'
- 39" = 390'
- 40" = 400'
- 41" = 410'
- 42" = 420'
- 43" = 430'
- 44" = 440'
- 45" = 450'
- 46" = 460'
- 47" = 470'
- 48" = 480'
- 49" = 490'
- 50" = 500'
- 51" = 510'
- 52" = 520'
- 53" = 530'
- 54" = 540'
- 55" = 550'
- 56" = 560'
- 57" = 570'
- 58" = 580'
- 59" = 590'
- 60" = 600'
- 61" = 610'
- 62" = 620'
- 63" = 630'
- 64" = 640'
- 65" = 650'
- 66" = 660'
- 67" = 670'
- 68" = 680'
- 69" = 690'
- 70" = 700'
- 71" = 710'
- 72" = 720'
- 73" = 730'
- 74" = 740'
- 75" = 750'
- 76" = 760'
- 77" = 770'
- 78" = 780'
- 79" = 790'
- 80" = 800'
- 81" = 810'
- 82" = 820'
- 83" = 830'
- 84" = 840'
- 85" = 850'
- 86" = 860'
- 87" = 870'
- 88" = 880'
- 89" = 890'
- 90" = 900'
- 91" = 910'
- 92" = 920'
- 93" = 930'
- 94" = 940'
- 95" = 950'
- 96" = 960'
- 97" = 970'
- 98" = 980'
- 99" = 990'
- 100" = 1000'

FRANCE STREET

CHARTRES STREET

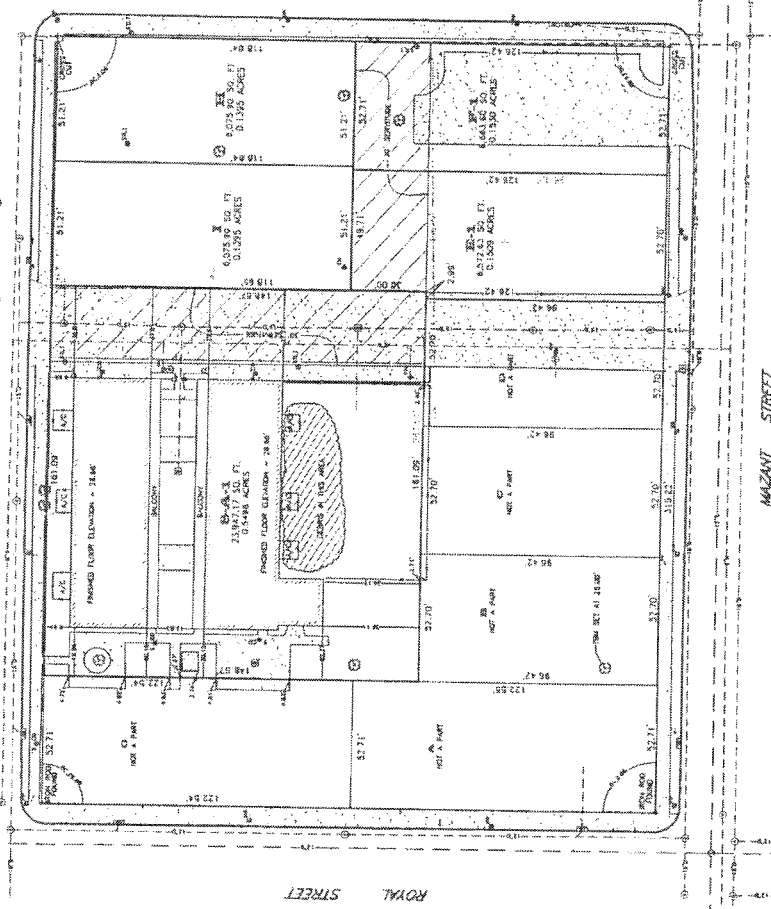

MAZANT STREET

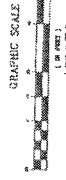

NOTICE: THIS SURVEYING INSTRUMENT HAS BEEN CALIBRATED AND FOUND TO BE ACCURATE FOR THE PURPOSES OF THIS SURVEY.

NOTICE: THE SURVEYING INSTRUMENT HAS BEEN CALIBRATED AND FOUND TO BE ACCURATE FOR THE PURPOSES OF THIS SURVEY.

NOTICE: THE SURVEYING INSTRUMENT HAS BEEN CALIBRATED AND FOUND TO BE ACCURATE FOR THE PURPOSES OF THIS SURVEY.

NOTICE: THIS SURVEYING INSTRUMENT HAS BEEN CALIBRATED AND FOUND TO BE ACCURATE FOR THE PURPOSES OF THIS SURVEY.

NOTICE: THIS SURVEYING INSTRUMENT HAS BEEN CALIBRATED AND FOUND TO BE ACCURATE FOR THE PURPOSES OF THIS SURVEY.

PLANNING NOTES:
 THIS SURVEY WAS MADE IN ACCORDANCE WITH THE PROVISIONS OF THE SURVEYING ACT OF 1968 AND THE REGULATIONS THEREUNDER. THE SURVEYING INSTRUMENTS USED WERE CALIBRATED AND FOUND TO BE ACCURATE FOR THE PURPOSES OF THIS SURVEY. THE SURVEYING INSTRUMENTS USED WERE CALIBRATED AND FOUND TO BE ACCURATE FOR THE PURPOSES OF THIS SURVEY. THE SURVEYING INSTRUMENTS USED WERE CALIBRATED AND FOUND TO BE ACCURATE FOR THE PURPOSES OF THIS SURVEY.

REFERENCE NOTES:
 THE SURVEYING INSTRUMENTS USED WERE CALIBRATED AND FOUND TO BE ACCURATE FOR THE PURPOSES OF THIS SURVEY. THE SURVEYING INSTRUMENTS USED WERE CALIBRATED AND FOUND TO BE ACCURATE FOR THE PURPOSES OF THIS SURVEY. THE SURVEYING INSTRUMENTS USED WERE CALIBRATED AND FOUND TO BE ACCURATE FOR THE PURPOSES OF THIS SURVEY.

GENERAL NOTES:
 THE SURVEYING INSTRUMENTS USED WERE CALIBRATED AND FOUND TO BE ACCURATE FOR THE PURPOSES OF THIS SURVEY. THE SURVEYING INSTRUMENTS USED WERE CALIBRATED AND FOUND TO BE ACCURATE FOR THE PURPOSES OF THIS SURVEY. THE SURVEYING INSTRUMENTS USED WERE CALIBRATED AND FOUND TO BE ACCURATE FOR THE PURPOSES OF THIS SURVEY.

PLANNING NOTES:
 THE SURVEYING INSTRUMENTS USED WERE CALIBRATED AND FOUND TO BE ACCURATE FOR THE PURPOSES OF THIS SURVEY. THE SURVEYING INSTRUMENTS USED WERE CALIBRATED AND FOUND TO BE ACCURATE FOR THE PURPOSES OF THIS SURVEY. THE SURVEYING INSTRUMENTS USED WERE CALIBRATED AND FOUND TO BE ACCURATE FOR THE PURPOSES OF THIS SURVEY.



RICHMOND W. KERENS
 PROFESSIONAL ENGINEER
 SURVEYING
 P.O. BOX 884
 METairie, LA. 70001-8841
 PHONE: (504) 888-0882
 FAX: (504) 888-0882
 CREW: (504) 888-0882

A REBUBDIVISION OF LOT 9-A, DIVISION P-1, THIRD DISTRICT, ORLEANS PARISH, LA.